



# STRUCTURAL PERMIT APPLICATION

## CITY OF SILVERTON

306 South Water St Silverton, OR 97381

Phone: 503-874-2207

Fax: 503-873-3210

E-mail: [permits@silverton.or.us](mailto:permits@silverton.or.us)

Web: [www.silverton.or.us/building](http://www.silverton.or.us/building)

### DEPARTMENT USE ONLY

Permit #:

Date:

Received By:

**This permit is issued under OAR 918-460-0030. Permits expire if work is not started within 180 days of issuance or if work is suspended for 180 days.**

CATEGORY OF CONSTRUCTION		
<input type="checkbox"/> Residential	<input type="checkbox"/> Government	<input type="checkbox"/> Commercial
JOB SITE INFORMATION AND LOCATION		
Job site address:		
Owner Name:		
Mailing Address:		
City:	State:	Zip:
Phone:		
Subdivision:		Lot no.:
Tax map/parcel no.		
PROPERTY OWNER INSTALLATION		
This installation is being made on residential or farm property owned by me or a member of my immediate family, and is exempt from licensing requirements under ORS 701.010.		
<b>Sign here:</b>		
CONTRACTOR INSTALLATION		
Business name:		
Address:		
City:	State:	ZIP:
Phone:	Fax:	
E-mail:		
CCB license no.:		
Print name:		
<b>Sign here:</b>		
APPLICANT (IF OTHER THAN OWNER OR CONTRACTOR)		
Business name:		
Address:		
City:	State:	ZIP:
Phone:	Fax:	
E-mail:		
<b>Sign here:</b>		

LOCAL GOVERNMENT APPROVAL	
This project has final land-use approval.	
Signature:	Date:
Zoning approval verified:	<input type="checkbox"/> Yes <input type="checkbox"/> No
Property is within flood plain:	<input type="checkbox"/> Yes <input type="checkbox"/> No
Historic District:	<input type="checkbox"/> Yes <input type="checkbox"/> No

FEE SCHEDULE		
1. Valuation information		
Job description/Other information:		
<input type="checkbox"/> new <input type="checkbox"/> alteration <input type="checkbox"/> addition - Add'l square feet:		
<b>Total valuation:</b>		\$
2. Building fees		
Permit fee (use valuation table on reverse)		\$
Solar Photovoltaic Systems Installed per Section 305.4 of the Oregon Solar Installation Specialty Code (OSISC). Includes application fee and one inspection.	\$75.00	\$
Excavating, Grading, and Fill Permits (use valuation table)		\$
12% State surcharge (.12 x all fees above)		
<b>Subtotal of fees above:</b>		\$
3. Plan review fees		
Residential Plan review (65% x permit fee)		\$
Commercial Plan review (85% x permit fee)		
Fire and life safety (100% x permit fee)		\$
Additional plan review required by changes to the approved plans. \$75.00/hr One hour minimum		\$
<b>Subtotal of fees above:</b>		\$
4. Miscellaneous fees		
Temporary Certificate of Occupancy.		
Commercial/multi-fam per 30 day period.	\$150.00	\$
1 & 2 Family Dwellings (one time fee)	\$ 50.00	
Zoning Surcharge	\$ 25.00	
New or replacement residence		
Reissuance Fee – fee to reissue a permit that will expire by limitation and the project has not been abandoned.	\$75.00	
Inspections for which no fee is specifically indicated One hour minimum	\$75.00 per hour	
Investigative fee, if applicable ( hours x \$75/hour):		
Inspection outside normal business hours: \$97.50/hr minimum two hours		
Reinspection fee, (if applicable)	\$75.00/hour	



**City of Silverton**  
306 S Water Street  
Silverton, OR 97381  
(503) 874-2207  
Fax (503) 873-3210

Site Address: \_\_\_\_\_

Permit # \_\_\_\_\_

**SUBCONTRACTOR REGISTRATION - New Home or ADU Construction Only**

**Mechanical Contractor Information:**

Contractor:		Contractor's Board No.
Mailing Address:		
Phone:	Fax:	Cell:

**Plumbing Contractor Information:**

Contractor:		Contractor's Board No.
Plumber's Board License:	Journeyman Plumbers License:	
Mailing Address:		
Phone:	Fax:	Cell:

**Electrical Contractor Information:**

Contractor:		Contractor's Board No.
Contractor License No.:	Supervisor License No.:	
Mailing Address:		
Phone:	Fax:	Cell:
Signature of Supervising Electrician:		

**Landscape Contractor Information (optional):**

Contractor:		Landscape Board No.
Mailing Address:		
Phone:	Fax:	Cell:

**City of Silverton**  
Public Works Department  
306 South Water Street  
Silverton, OR 97381  
Phone (503) 873-8679  
Fax (503) 873-3210



**GENERAL RIGHT OF WAY IMPROVEMENT PERMIT APPLICATION**

**Job Address:** \_\_\_\_\_

**Property Owner:**

**Contractor:**

**Name:** \_\_\_\_\_

**Name:** \_\_\_\_\_

**Address:** \_\_\_\_\_

**Address:** \_\_\_\_\_

**Telephone:** \_\_\_\_\_

**Telephone:** \_\_\_\_\_

**CCB:** \_\_\_\_\_

**Insurance Co.** \_\_\_\_\_

**Property Use:**  Residential       Commercial       Other: \_\_\_\_\_

The listed fees do not include any additional permit fees from ODOT or Marion County, if applicable. The permit fees are separate and independent of each other.

Building Department to include the City Engineer or his designee's approval of any required public sidewalk construction as a condition to the occupancy permit.

I hereby acknowledge that I have read this application and state that the foregoing is correct. I agree to comply with all City Ordinances, special provisions and City standards included herein.

I shall indemnify and save harmless the City of Silverton and its employees from all suites actions, or claims of any character brought because of any injuries and/or damages received or sustained by any person, or property on account of the operations of myself, my subcontractors or the employees of either; or on account of or in consequence of any neglect in safeguarding the work; or because of any act or omission, neglect or misconduct of myself.

**Applicant:** \_\_\_\_\_ **Date:** \_\_\_\_\_

Proposed Improvement – Please Check Box:

	Fee	Total Fee
<b>SIDEWALK</b>		
New or Replacement Construction Permit Fee	\$88.00	
<b>DRIVEWAY</b>		
New or Replacement Construction Permit Fee	\$88.00	
<b>CURBING</b>		
New or Replacement Construction Permit Fee	\$88.00	
<b>SANITARY OR STORM SERVICE LINE</b>		
New or Replacement Construction Permit Fee	\$88.00	
Tapping Fee (Service taps to be done by City Forces)	\$260.00	
Returnable Performance Deposit	\$1,000.00	
<b>WATER LINE</b>		
New or Replacement Construction Permit Fee	\$88.00	
Tapping Fee (Service taps to be done by City Forces)	\$275.00	
<b>STREET CUT</b>		
Existing Surfaced Street Cut and Repair Permit Fee	\$183.00	
(City required compaction test to be paid for by permittee)		

Schedule of Fees – RES. NO. 14-13

FOR OFFICE USE ONLY:

Application Received:

By: \_\_\_\_\_

Total Fee: \_\_\_\_\_

Date: \_\_\_\_\_

Permit Number: \_\_\_\_\_

Site Plan Accepted (if applicable) \_\_\_\_\_

Date: \_\_\_\_\_

## SIDEWALK AND DRIVEWAY SITE PLAN

Site Plan should include information as shown below:

Show North Arrow Direction

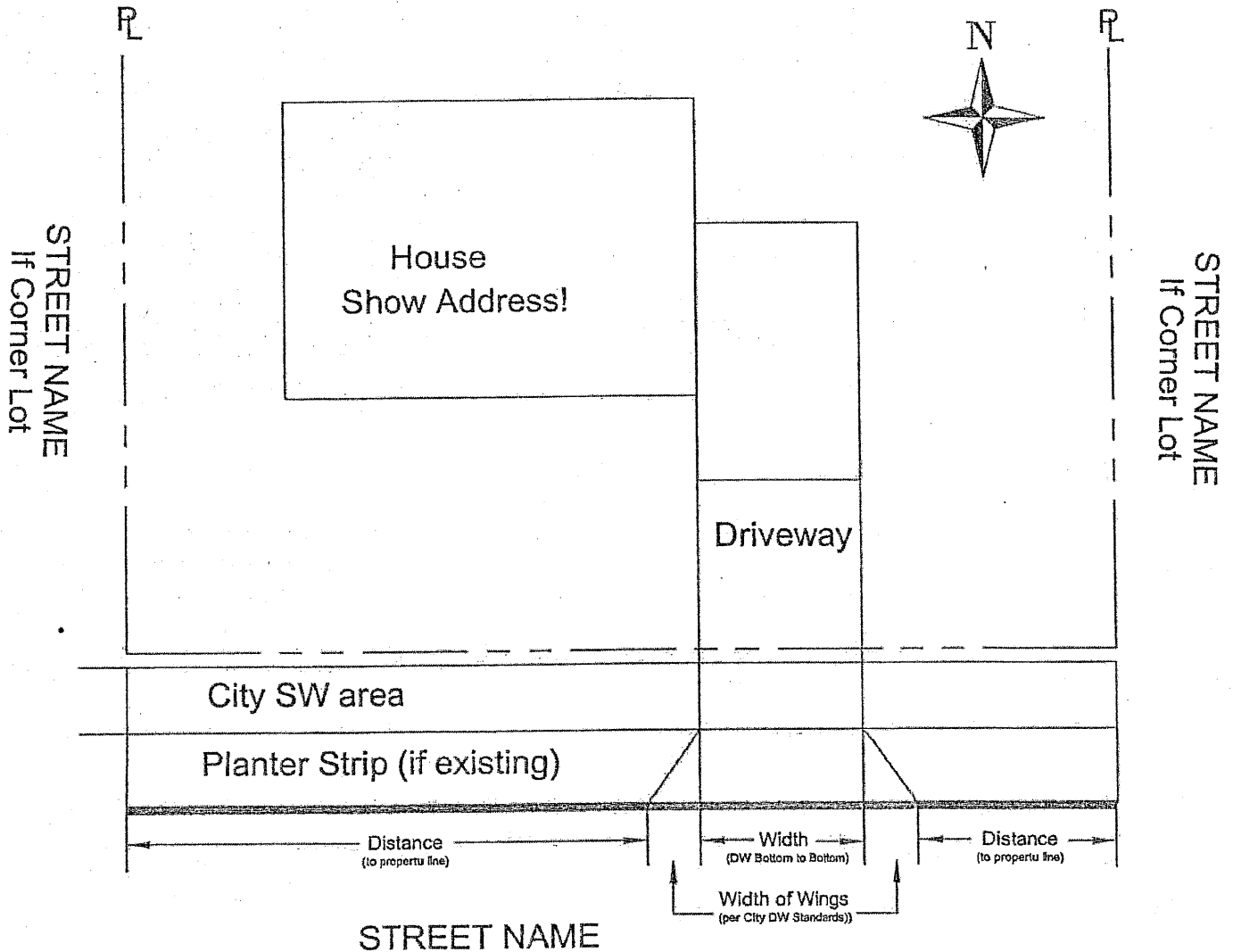

Site Plan should also include locations of the following:

Water Meter Box

Sanitary and/or Storm Sewer Cleanout Boxes (if known)

Utility Lines in City ROW

Catch Basins (if located in street fronting property)

Fire Hydrant (if on property frontage)

Existing Gate Valve Box

Rain Drain and Curb Weepholes

**SITE PLAN MUST BE APPROVED BY  
CITY ENGINEERING STAFF**